



SYNCHROTRON
THAILAND
CENTRAL LAB

Proposal for JACoW Team Meeting 2020 in Bangkok, Thailand

Thakonwat Chanwattana
on behalf of SLRI

29 Jan 2020

SLRI

- Synchrotron Light research Institute (SLRI) is the only one synchrotron light source facility in Thailand located in Nakhon Ratchasima or Korat, a big city 250 km North-East of Bangkok.
- SLRI is going to host IPAC'22 in Bangkok.
- IPAC'22 will be the very first JACoW conference organized in Thailand and South East Asia.



*We would like to invite JACoW team members to have the Team Meeting 2020 (TM'20) in **Bangkok**.*

Proposed dates for TM'20: **15-20 November 2020**

Weather during October and November

- Average temperature: 28 °C (high 31 °C, low 24 °C)
- Season: rainy to winter (still quite hot)
- You can expect the sun most of the daytime!

Proposed location

We propose to have the team meeting in Bangkok.



The Grand Palace



Lots of Shopping Centres



Nightlife at Khaosan Road



Enjoy street foods on Yaowarat Walking Street



Shopping at Asiatique The Riverfront

And a lot more for you to discover in Bangkok!

Transportation

Suvarnabhumi International Airport (BKK)



Transportation from the airport to Bangkok city centre

Airport Rail Link



Shuttle bus and special bus



Taxi or Grab (like Uber)



Proposed Venue

Arnoma Grand Hotel, Bangkok (<https://www.arnoma.com/>)

- Locate in centre of Bangkok, Ratchaprasong area, with lots of shopping malls, bars and restaurants
- Easy access from Suvarnabhumi Airport and to get around Bangkok
- Great venue for meetings with professional AV equipment and sound systems
- Leisure function: fitness centre, sauna, outdoor swimming pool, Thai spa and pool bar



Recommended transportation from the airport to the hotel

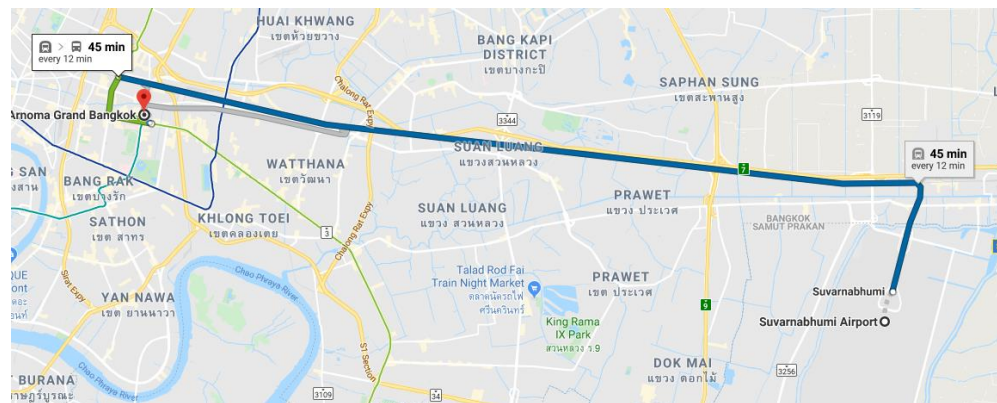

Airport Rail Link



BTS Skytrain

45 minutes from Suvarnabhumi Airport by taking

- Airport Rail Link to **Phaya Thai**
- BTS Skytrain [Sukhumvit Line] to **Chit Lom**
- 500m walk or taking a taxi to the hotel

BTS stations and places nearby

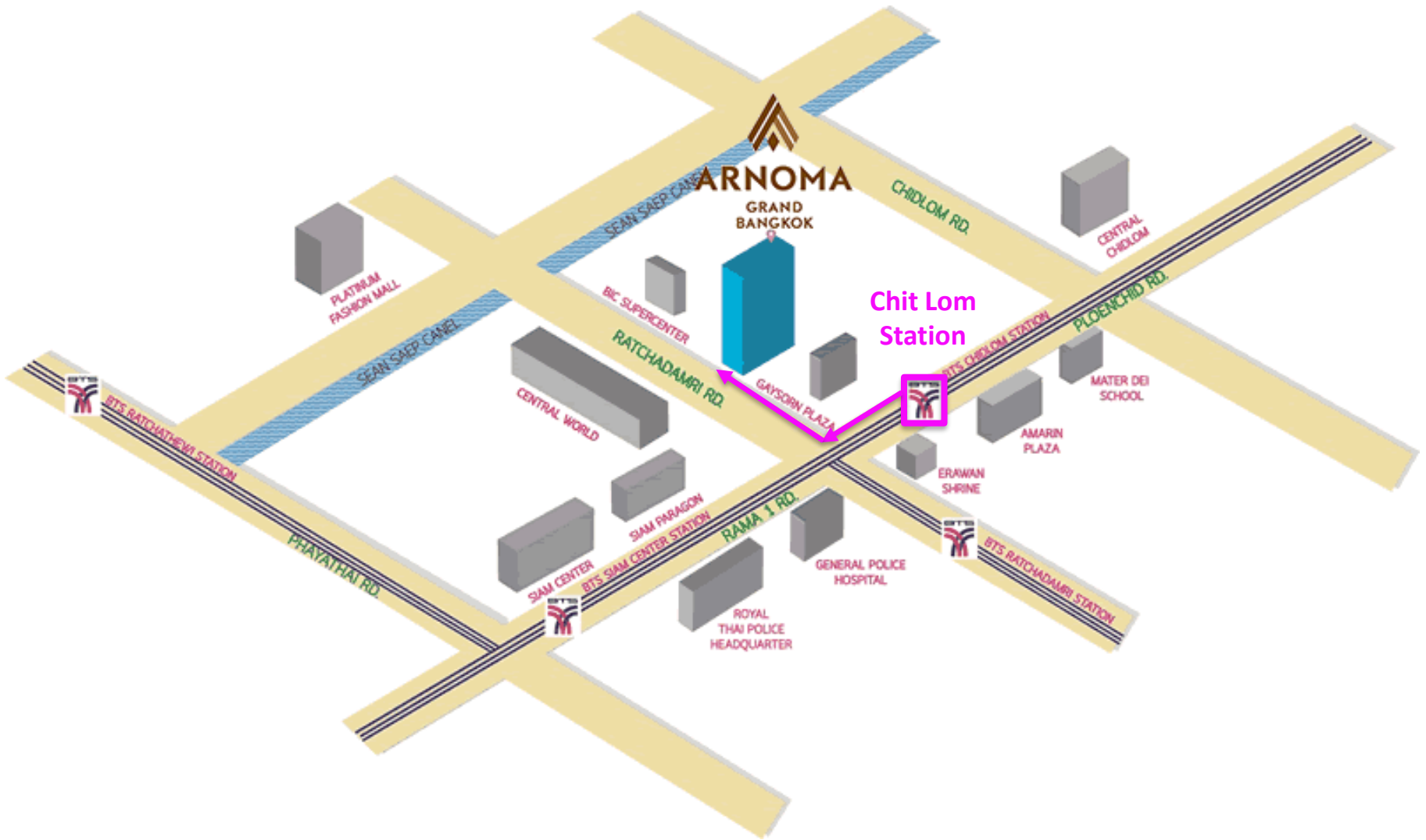

Accommodation

Superior Room (28 m²)



Double and twin bedded rooms available

Deluxe Room (34 m²)



Double and twin bedded rooms available

Room rate per night	THB	USD
Superior	2600	86
Deluxe	2800	93



Meeting rooms: floor plan



23RD FLOOR

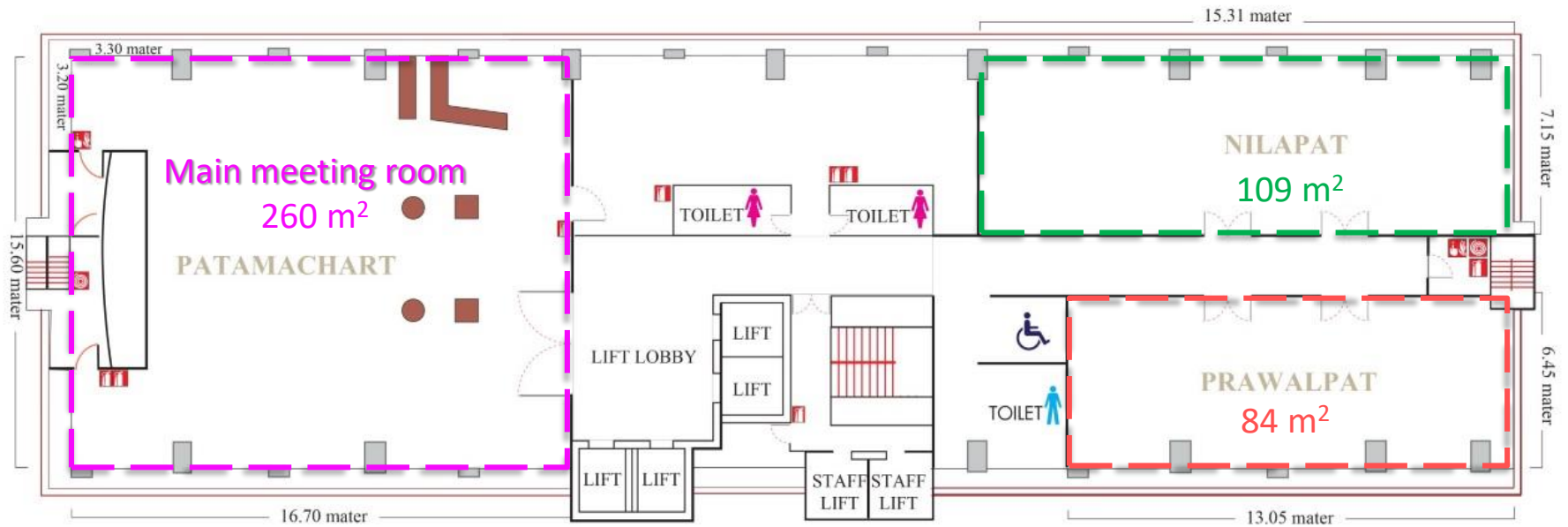

Meeting rooms

Patamachart (260 m²)



Prawalpat (84 m²)



Nilapat (109 m²)



Patamachart arranged in class room style



Catering

Breakfast, lunch and coffee break served by Arnoma Grand Hotel



Mango with sticky rice



Cocktail reception

Floor Plan : 3rd Floor

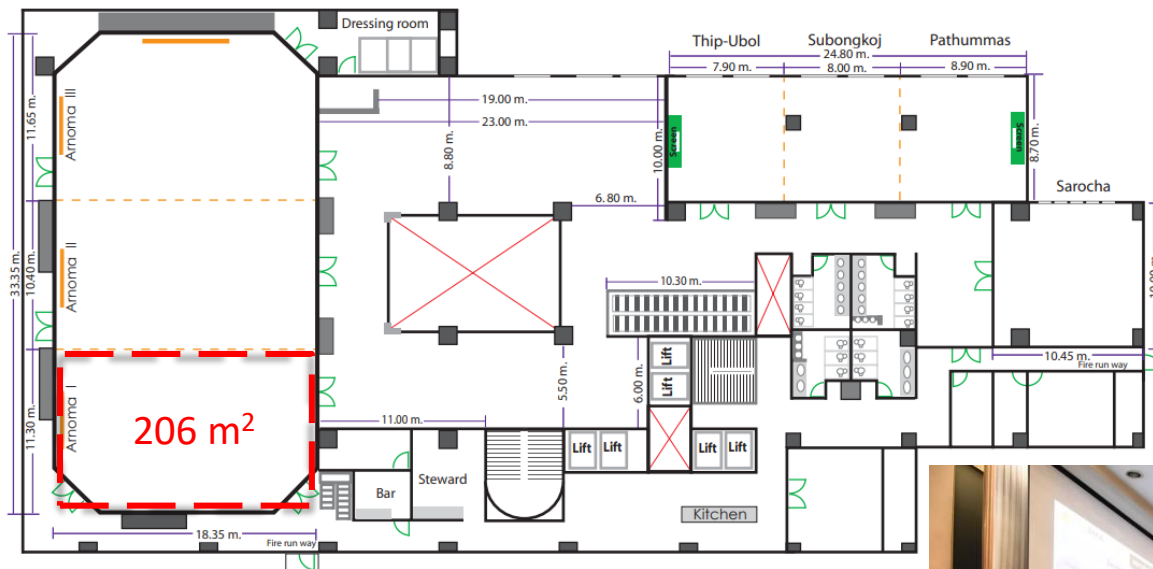

Venue surroundings



Central World



Siam Square One



Bangkok Art and Culture Centre



Siam Paragon



Sea Life Bangkok Ocean World



Pathum Wanaram Temple



Gayson Village



Madame Tussauds Bangkok



Jim Thompson Museum

and a lot more to be discovered ...

Bangkok Street Foods



Khao Pad Krapow
(Stir-fried holy basil on rice)



Pad Thai
(Thai stir-fried rice noodles)



Khao Neow Moo Ping
(Grilled pork skewers with sticky rice)



Khao Man Gai
(Poached chicken on seasoned rice)



Khanom Khrok
(Coconut-rice pancakes)



Khanom Bueang
(Thai crepes)

and more for you to try ...

JACoW Team dinner: Dine on Floating Restaurant

Enjoy dinner on a cruise with Thai historical landmarks and remarkable sceneries along Chao Phraya river



Estimate cost: 50 participants

Date	Time	Detail	Price [USD]
Sunday	09.00-18.00	Pre-team meeting [Room Prawalpat] with 2 coffee breaks and lunch (10 people)	298
Monday	09.00-16.00	Pre-team meeting [Room Prawalpat] with 2 coffee breaks and lunch (10 people)	298
	16.00-18.00	Kick-off session [Room Patamachart] Reception cocktail [Room Arnoma 1] (40 people)	1321
Tuesday	09.00-16.00	Team meeting [Room Patamachart] with 2 coffee breaks and lunch (50 people)	1486
	13.00-16.00	Parallel sessions [Room Patamachart , Prawalpat , Nilapat] Reception cocktail [Room Arnoma 1] (50 people)	529
			1651
Wednesday	09.00-16.00	Team meeting [Room Patamachart] with 2 coffee breaks and 1 lunch (50 people)	1486
	13.00-16.00	Parallel session [Room Patamachart , Prawalpat , Nilapat]	529
Thursday	09.00-16.00	Team meeting [Room Patamachart] with 2 coffee breaks and 1 lunch (50 people)	1486
	13.00-16.00	Parallel session [Room Patamachart , Prawalpat , Nilapat]	529
		Team dinner (50 people)	2476
Friday	09.00-12.00	Team meeting [Room Patamachart , Prawalpat , Nilapat (half day)] with 1 coffee break and 1 lunch (50 people)	1321
		Miscellaneous costs (internet 30MB)	238
		Total cost (based on 50 participants)	13648
		Estimate registration fee	273

Estimate cost: 40 participants

Date	Time	Detail	Price [USD]
Sunday	09.00-18.00	Pre-team meeting [Room Prawalpat] with 2 coffee breaks and lunch (10 people)	298
Monday	09.00-16.00	Pre-team meeting [Room Prawalpat] with 2 coffee breaks and lunch (10 people)	298
	16.00-18.00	Kick-off session [Room Patamachart] Reception cocktail [Room Arnoma 1] (32 people)	1057
Tuesday	09.00-16.00	Team meeting [Room Patamachart] with 2 coffee breaks and lunch (40 people)	1189
	13.00-16.00	Parallel sessions [Room Patamachart , Prawalpat , Nilapat] Reception cocktail [Room Arnoma 1] (40 people)	529
			1321
Wednesday	09.00-16.00	Team meeting [Room Patamachart] with 2 coffee breaks and 1 lunch (40 people)	1189
	13.00-16.00	Parallel session [Room Patamachart , Prawalpat , Nilapat]	529
Thursday	09.00-16.00	Team meeting [Room Patamachart] with 2 coffee breaks and 1 lunch (40 people)	1189
	13.00-16.00	Parallel session [Room Patamachart , Prawalpat , Nilapat]	529
		Team dinner (40 people)	1981
Friday	09.00-12.00	Team meeting [Room Patamachart , Prawalpat , Nilapat (half day)] with 1 coffee break and 1 lunch (40 people)	1057
		Miscellaneous costs (internet 30MB)	238
		Total cost (based on 40 participants)	11404
		Estimate registration fee	285

Excursions

Ayutthaya is the ancient Thai city

82 km from Bangkok: 1.5 hours by train, 1 hour by bus/mini-van



Pattaya is a beach city with famous walking street

150 km from Bangkok: 3 hours by bus, 2 hours by mini-van



Excursions

Phuket is a southern island with most popular beaches

840 km from Bangkok: 1.5 hours by air, 12 hours by train, 16 hours by bus



Chiang Mai is a mountainous northern city with beautiful nature and unique culture

680 km from Bangkok: 1.5 hours by air, 12 hours by train, 12 hours by bus



Facility Tour

A one day facility tour to Siam Photon Source (SPS) is possible.

Travel from Bangkok to SLRI in Nakhon Ratchasima takes about 4 hours by car/bus.

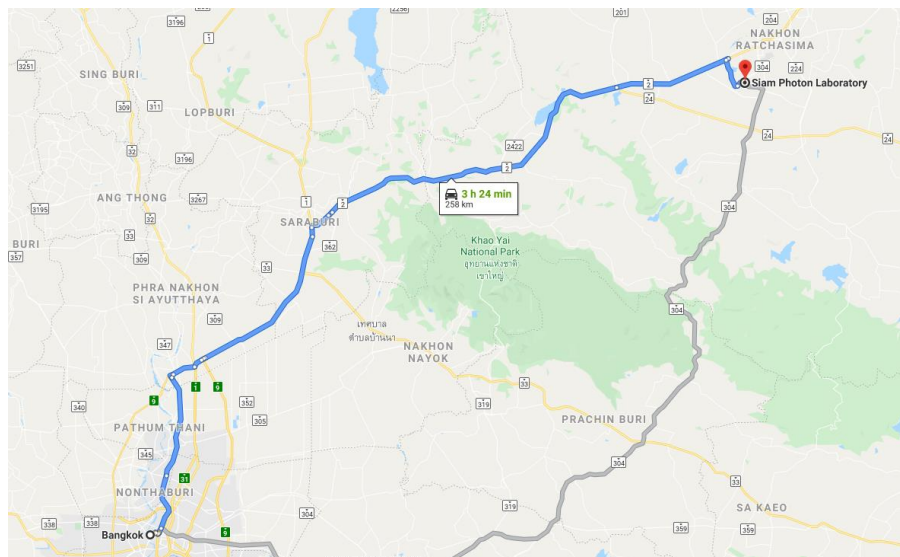

Siam Photon Source (SPS) has been operated as a synchrotron light source facility for almost 20 years.

Proposal for TM'20 in Bangkok

Proposed dates: 15-20 November 2020

Venue: Arnoma Grand Hotel, Bangkok

Accommodation cost: ~100 USD per day

Estimate registration fee: 270-290 USD

Opportunity to Host the team meeting in Thailand will engage more of our staffs to the JACoW collaboration and to be ready for the upcoming IPAC'22.



*OUR TEAM LOOK FORWARD TO
WELCOMING THE JACoW TEAM
IN BANGKOK*